

## FOREVERGREEN FARMS

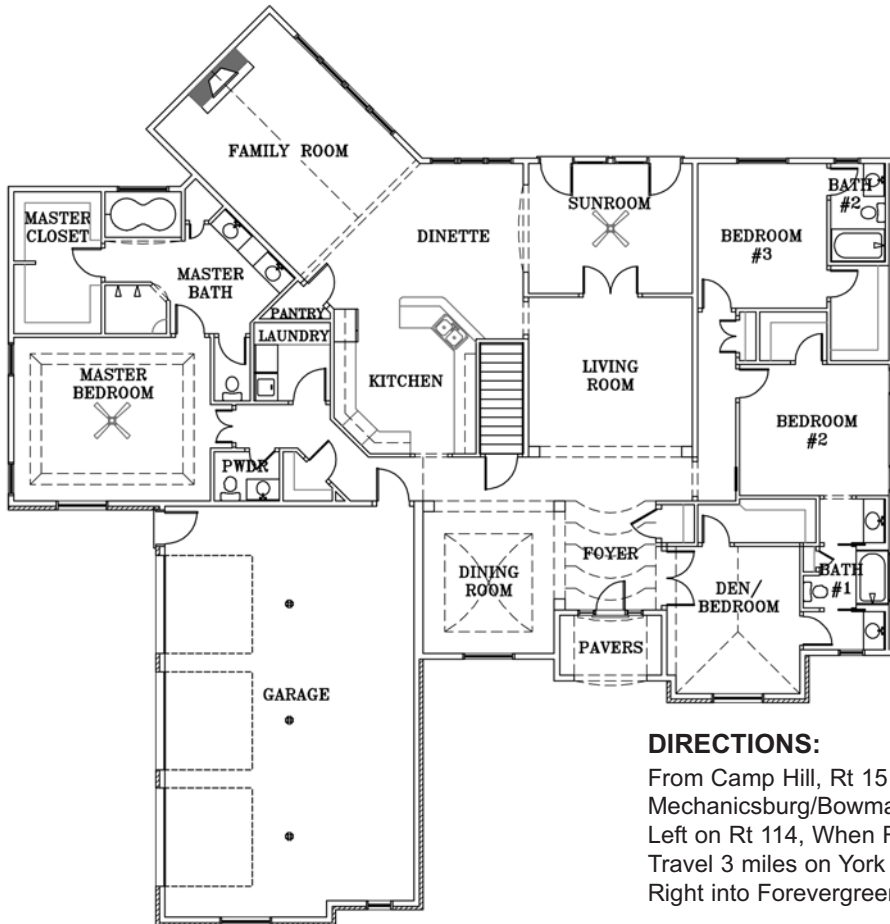

**ROLAND BUILDER**  
• CUSTOM HOMES •

**697-8643**

**\$674,700.00**

4 Bedrooms, 3 1/2 Baths  
One-story living with the  
finest amenities.

### DIRECTIONS:

From Camp Hill, Rt 15 South to the  
Mechanicsburg/Bowmansdale Exit.  
Left on Rt 114, When Rt 114 turns Left, STAY STRAIGHT  
Travel 3 miles on York Rd; Right onto Saw Mill Rd,  
Right into Forevergreen Farms.

[www.rolandbuilder.com](http://www.rolandbuilder.com)

# FOREVERGREEN FARMS

