

ROLAND BUILDER NEWS

Volume 3, Issue 1

SUMMER 2006

NEW COMMUNITY - LIBERTY POINT

This summer we purchased our first development: Liberty Point. This scenic piece of land possesses 16 beautiful wooded home sites ranging in size from 0.34 to 3.30 acres. The most exciting aspect of this development is that Roland Builder will be the exclusive home builder. The consistency of quality and style will be upheld to the highest degree. As in our Garden Homes of Witney Ridge, we will offer lawn care and snow removal. Site improvements will be taking place during the next few months. We anticipate the construction of our first model to begin in October of this year. Call now to reserve a lot, 697-8643.



Directions:

RT 15 to Rossmoyne Rd/Wesley Drive exit
 Take Rossmoyne Rd to Lisburn Rd.
 Turn Right on Lisburn Rd.
 Travel ½ mile, turn Left on Thompson Lane
 Travel ½ mile to the Liberty Point entrance on the Right

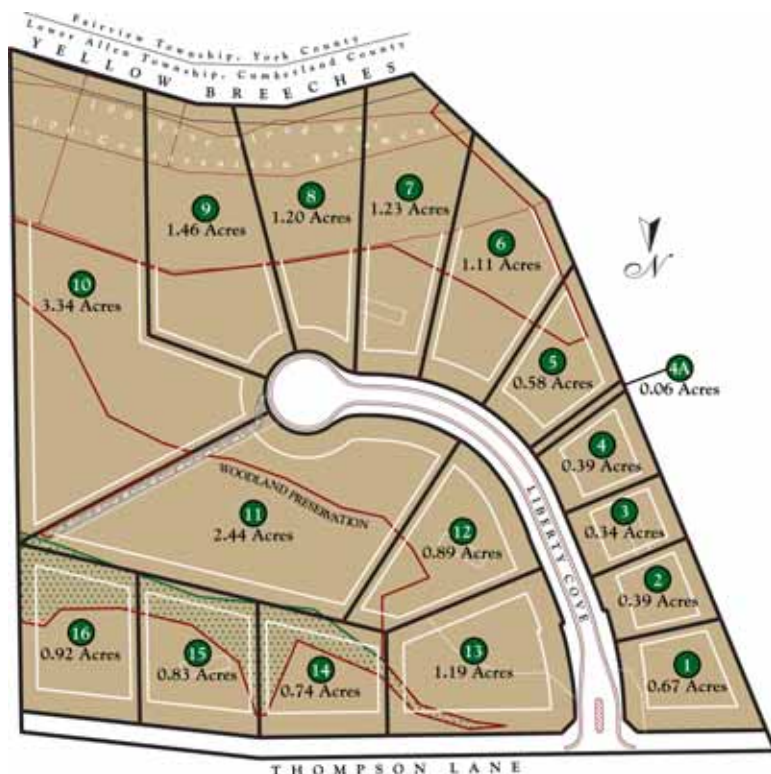

Inside this issue:

Subcontractor Spotlight	2
New Model	2
Lots Available	2
Client Testimonial	3
Pyramid Awards	3

GARDEN HOME UPDATE

The success of the Garden Homes of Witney Ridge continues. Presently two lots are available and two are on hold. Please visit our new two-story office/model at 100 Windrush Lane, or call (717) 697-8643 for more details.

Subcontractor Spotlight -- *Classic Accents of Hershey, Inc.*

For over 10 years, Classic Accents of Hershey, Inc. has provided our company with superior window and door products.

The front door is a focal point that everyone notices, so we choose beautiful front doors to enhance the curb appeal of each home we build. Classic Accents provides us with a superior product for this area of the house.

For each house we build, Classic Accents provides us with high-quality Andersen windows and

exterior doors. For interior doors, they supply us with Simpson doors that are ready to be painted or stained. Classic Accents also offer stair parts such as wrought iron railing and balusters that we use in many homes. The railings we select are typically a key feature in many of our homes. They provide the type of quality that adds to the "wow factor" that we try to achieve.

Bill Farr, owner of Classic Accents, provides our company with outstanding customer service. His attention to detail ensures that we

order exactly what we need and that it arrives in flawless condition. In the rare instance that an issue does arise with a delivered product, he always finds a remedy quickly so we are able to stay on schedule.

We look forward to a long and productive relationship with Bill Farr and Classic Accents for many years to come.

To nominate one of our sub-contractors for the next issue, please email Brent Roland broland@rolandbuilder.com ■

NEW MODEL (Under construction) --- Estates of Forest Hills



We began this model home with the goal of creating something new and exciting. We feel that we have more than accomplished that with the home at 2413 Kensington way.

5 Bedrooms, 4 1/2 baths, 3 car garage. Come see it during the Parade of Homes, 2006 (September 30 - October 8)

*2413 Kensington Way,
Harrisburg, PA* ■

LOTS AVAILABLE

We currently have 8 lots available in local developments.

Liberty Point	1 - 16	(West Shore)
Estates of Forest Hills	Lot 2, 136, 158	(East Shore)
Lindenwood	Lots 36, 64	(West Shore)
Manor at Fair Oaks	Lot 38	(West Shore)
Wentworth Estates	Lot 54, 55	(West Shore)

For more information call 697-8643 or visit our web site www.rolandbuilder.com

client testimonial

"Just wanted to send you a letter of appreciation for the great job your company did constructing our new home in ForEvergreen Farms. When Heather and I decided to build our first home, I was torn between administering the project myself or contracting it out to a residential builder. Being in the construction industry, I have heard all of the horror stories related to home builders and I was hesitant in turning over the responsibility of the construction of our "dream" home. After a lot of research of local custom home builders, as well as evaluating my own workload, Heather and I decided to contact your firm. Now that our home is complete, we can both say that without a doubt, we made the right decision.

"W. Lee Roland Builder provided "one-stop shopping" for us throughout the construction process. Both of you helped us in acquiring the property, securing the necessary financing, and designing the home with our needs

and budget in mind. The construction process also went extremely well, as there was continuous progress from start to finish. We would also like to commend your staff and subcontractors. All of your employees were very helpful and committed to our satisfaction. The quality workmanship of your finish carpenters is unmatched and Rolla did an outstanding job managing



the project and fielding all of my phone calls. The same can be said for the subcontractors who worked on our home, as each of them were courteous and attentive to our questions and

requests. To sum it up, your firm handled the problems which minimized our headaches, our house was completed on schedule, our change orders were minimal, and we are both extremely happy with the finished product. What more could we have asked for?

"In our industry, it is not very often that we get to hear the positive feedback from our customers. As General Contractors, it is our job to deal with the negative issues such as material delivery delays, roof leaks, bad weather, unhappy owners, and non-performing subcontractors on a daily basis. What separates the exceptional contractors from the rest of the industry is how they handle these situations. I believe that a successful company deals with these types of issues honestly and treats all of the parties involved fairly. Based on our experience, Heather and I both believe that W. Lee Roland Builder is an exceptional contractor!"

--- Frank & Heather Eichelberger ■

PYRAMID AWARDS 2005

Marketing Awards

Best Brochure (Company)
 Best Brochure (Community)
 Best Web Site by a Builder
 Best Interior Decorating (Over \$100,000)
 Best Advertisement (Radio)
 Best Advertisement (TV)
 Best Landscaping (Model)
 Best Landscaping (Sales Office)
 Best Model Sales Office
 Marketing Director of the Year - Brent Roland

Builder Awards

Single Family Model/Spec home (2,001 - 3,000 sq. ft)
 Custom Home of the Year (Under 500,000)

Remodeling Awards

Best Outdoor Living: Decks, Patios, and Enclosures - (Under \$25,000)

Associated Professional Awards

Best Subcontractor - David F. McClure Company (Justin McClure)
 Best Project Manager - Rolla Lehman

*Our most successful
 Pyramid Awards to date!*



100 Windrush Lane
Mechanicsburg, PA 17055



NEWSLETTER – SUMMER 2006, VOLUME 3, ISSUE 1

FOREVERGREEN FARMS



New model currently under construction.
One-story living with 4 Bedrooms, 3 1/2
baths, and the finest amenities. Available
for purchase, Fall 2006

Directions:

RT 15 to Mechanicsburg/Bowmansdale Exit
Take RT114 East
At the bottom of Bowmansdale hill where 114 turns left,
go straight ahead approx. 3 miles to Saw Mill Road.
Turn right onto Saw Mill; proceed 1 mile, turn
right into Forevergreen (Tannenbaum Circle;
First house on right.

ROLAND BUILDER, INC.

Phone: (717) 697-8643 | Fax: (717) 697-5889

Email: homes@rolandbuilder.com | Web site: www.rolandbuilder.com