

ROLAND BUILDER NEWS

Volume 7, Issue 1

WINTER 2010

DOUBLE FULTON AWARD WINNER!



We were very successful with this year's Parade of Homes, winning 2 Fulton Awards. The custom home above won in the category, Over 2 Million while the model home below won in the \$375,000 to \$500,000 category. Both homes are brand new with the latest features and amenities.

The Garden home to the right is our latest model home in Liberty Point. It features one floor living with 3 Bedrooms and 2 Baths. The home is Energy Star certified. The home boasts 10 foot ceilings throughout with a cathedral ceiling in the Great Room. The beautiful sunroom features a vaulted ceiling and sliding door with access to the rear deck. The master bedroom features a lighted tray ceiling. The bath is complete with whirlpool tub and walk-in ceramic shower with body

sprays. A large walk-in closet has wire and built-in wood shelving. This home is open Mon. - Fri. - 8 AM to 4:30 PM. The home below is currently under contract so construction will begin on a brand new one-story model for the upcoming 2011 Parade of Homes. See our web site for more details. www.rolandbuilder.com

Parade OF Homes

Visit www.paparadeofhomes.com for more information.



Inside this issue:

Liberty Point	2
Lots Available	2
Home-A-Rama	3
Subcontractor Spotlight	3
Home for Sale	3

What's New?

Effective January 1, 2011 One and Two family dwellings will be required to have automatic fire sprinklers installed as per the 2009 IRC.

There are two exceptions to these requirements.

(A) If a design or construction contract for dwellings is signed prior to Dec. 31, 2010, the work will comply with the 2006 International Residential Code.

(B) If an application is submitted for a UCC building permit prior to either of the effective dates of the sprinkler requirement, the residential construction will not be subject to it.



16 gorgeous wooded home sites with incredible views. Lawn mowing and snow removal provided.

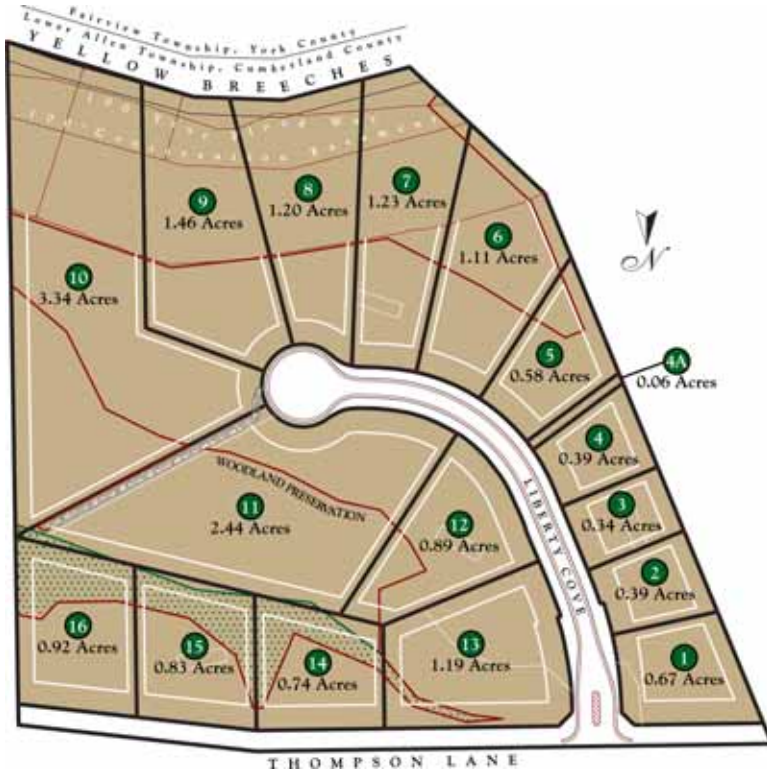

HOME SITE PRICING

1	Office/Model
2	SOLD
3	\$110,000
4	SOLD
5	Model - Under Contract
6	\$149,000
7	\$152,000
8	\$151,000
9	\$156,000
10	SOLD
11	\$169,000
12	\$146,000
13	\$145,000
14	\$97,000
15	\$98,000
16	\$99,000

LOTS AVAILABLE

We have several lots in local developments.

Liberty Point (West Shore)	Lots 3, 6- 9, 11-16
Estates of Forest Hills (East Shore)	Lots 2, 137, 154, 158
Lindenwood (West Shore)	Lots 36, 64
Manor at Fair Oaks (West Shore)	Lot 38

*Now approved to build in:
 Fishing Creek Estates, Mountindale, Sterling Glen,
 and the Preserve at Simmons Creek!*



OPEN HOUSE
 Monday - Friday 8:00 AM - 4:30 PM
 Sundays 2 - 4 PM

Directions:

RT 15 to Rossmoyne Rd/Wesley Drive exit
 Take Rossmoyne Rd to Lisburn Rd.
 Turn Right on Lisburn Rd.
 Travel ½ mile, turn Left on Thompson Lane
 Travel ½ mile to the Liberty Point entrance on the Right

Home A Rama

BUILDERS' SHOWCASE



Let us build your dream home for the 2011 Home-A-Rama and receive numerous FREE amenities. The show is in June, move in July 2011. Call today to review plans and specs 717-697-8643

Subcontractor Spotlight

DOWN EAST FABRICATION

In business since 1989, Down East Fabrication is currently Central Pennsylvania's leading fabricator of Corian, Zodiaq, Natural Granite and Cambria Quartz surfaces.

They have a skilled team of craftsmen dedicated to providing quality workmanship for every project and their production facility is state of the art. Visit their showroom and see the many options available for your kitchen and bath. Their customer service and sales professionals are very knowledgeable and friendly. Their sincere effort makes our jobs easier.

Down East Fabrication has continued to earn our trust and confidence in the quality of their work and the excellent customer service provided to our clients. Roland Builder, Inc. is pleased to recognize the entire team at Down East Fabrication as our featured Subcontractor. ■

FOREVERGREEN FARMS

\$629,000



2 Tannenbaum Circle | Dillsburg, PA

- One-story living with 4 bedrooms, 3 1/2 baths
- Custom kitchen with high-end appliances
- 2.6 acre lot

Directions:

RT 15 to Mechanicsburg/Bowmansdale Exit
 Take RT 114 East. Where RT 114 turns left, go straight ahead approx. 3 miles to Saw Mill Road.
 Turn right onto Saw Mill; proceed 1 mile, turn right into Forevergreen on Tannenbaum Circle



697-8643

1706 Liberty Cove
Mechanicsburg, PA 17055



NEWSLETTER -- WINTER 2010, VOLUME 7, ISSUE 1



*Wishing you & your family,
Merry Christmas
and
Happy New Year!
Lee, Rosalie, Brent & Brad*

ROLAND BUILDER, INC.

Phone: (717) 697-8643 | Fax: (717) 697-5889

Email: homes@rolandbuilder.com | Web site: www.rolandbuilder.com